

1, Sullivans Reach, Walton-On-Thames, KT12 2QB

Energy Efficiency Rating		Current	Potential
Very energy efficient - lower running costs			
(92 plus) A			
(81-91) B			
(69-80) C			
(55-68) D			
(39-54) E			
(21-38) F			
(1-20) G			
Not energy efficient - higher running costs			
		58	76
England & Wales		EU Directive 2002/91/EC	

Environmental Impact (CO ₂) Rating		Current	Potential
Very environmentally friendly - lower CO ₂ emissions			
(92 plus) A			
(81-91) B			
(69-80) C			
(55-68) D			
(39-54) E			
(21-38) F			
(1-20) G			
Not environmentally friendly - higher CO ₂ emissions			
England & Wales		EU Directive 2002/91/EC	



£325,000 Leasehold

Conveniently located in the popular area of Sullivans Reach, Walton-On-Thames, this beautifully presented ground floor flat offers a delightful living experience. With two well-proportioned bedrooms, this property is perfect for individuals, couples, or small families seeking a comfortable home.

The modern fitted kitchen is a standout feature, providing a stylish and functional space for culinary enthusiasts. It is designed to meet the needs of contemporary living, making meal preparation a pleasure. The modern shower room complements the apartment, offering a fresh and inviting atmosphere.

One of the key highlights of this property is the direct access to the communal gardens at the rear. This outdoor space is ideal for relaxation or social gatherings, allowing residents to enjoy the beauty of nature right at their doorstep.

Situated within a riverside development, this maisonette is conveniently located close to Walton town centre, where a variety of shops, cafes, and amenities await. The combination of a tranquil setting and proximity to local conveniences makes this property an attractive option for those looking to enjoy the best of both worlds.

In summary, this two-bedroom flat in Sullivans Reach is a wonderful opportunity for anyone seeking a modern and well-located home in Walton-On-Thames. With its appealing features and communal gardens, it promises a comfortable and enjoyable lifestyle.

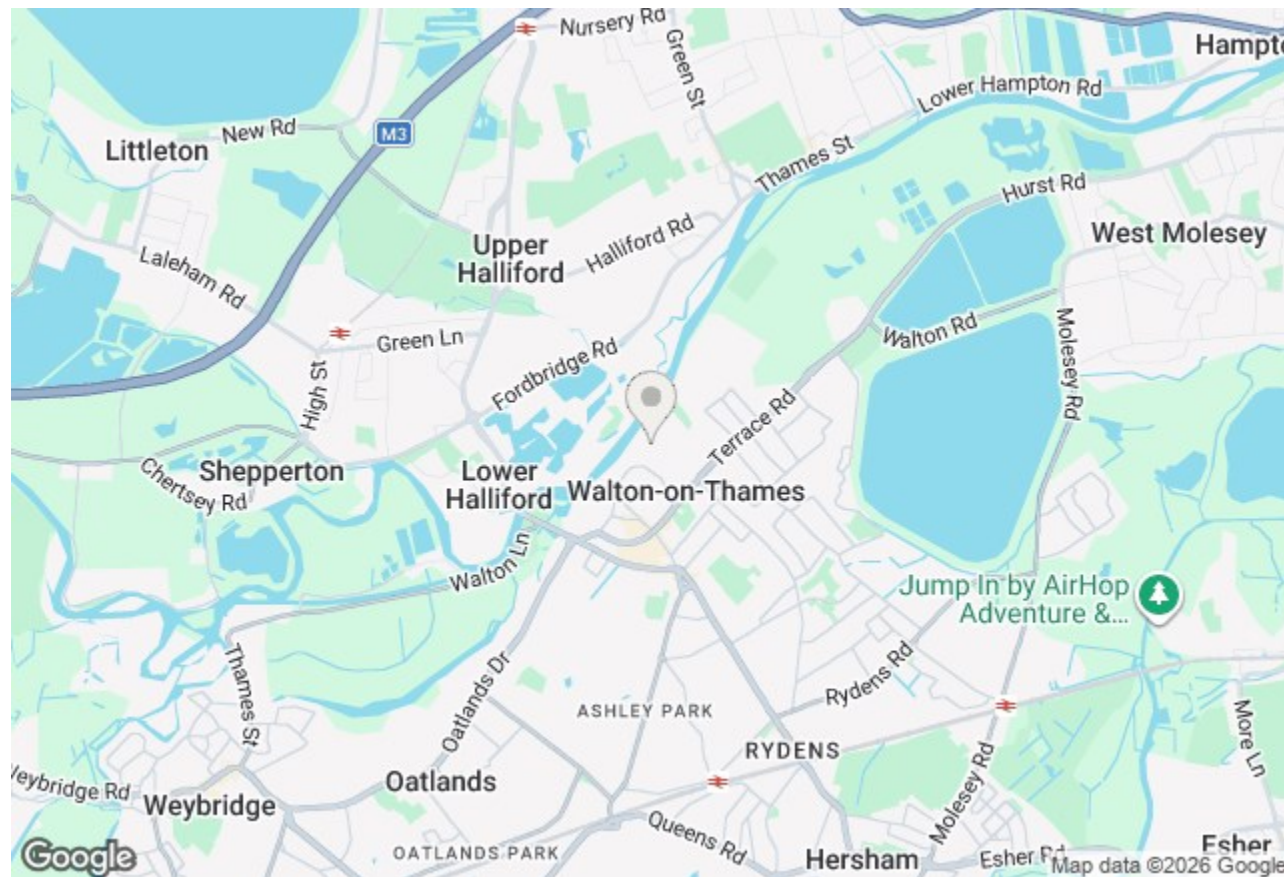

Sullivans Reach, Walton-On-Thames, KT12 2QB

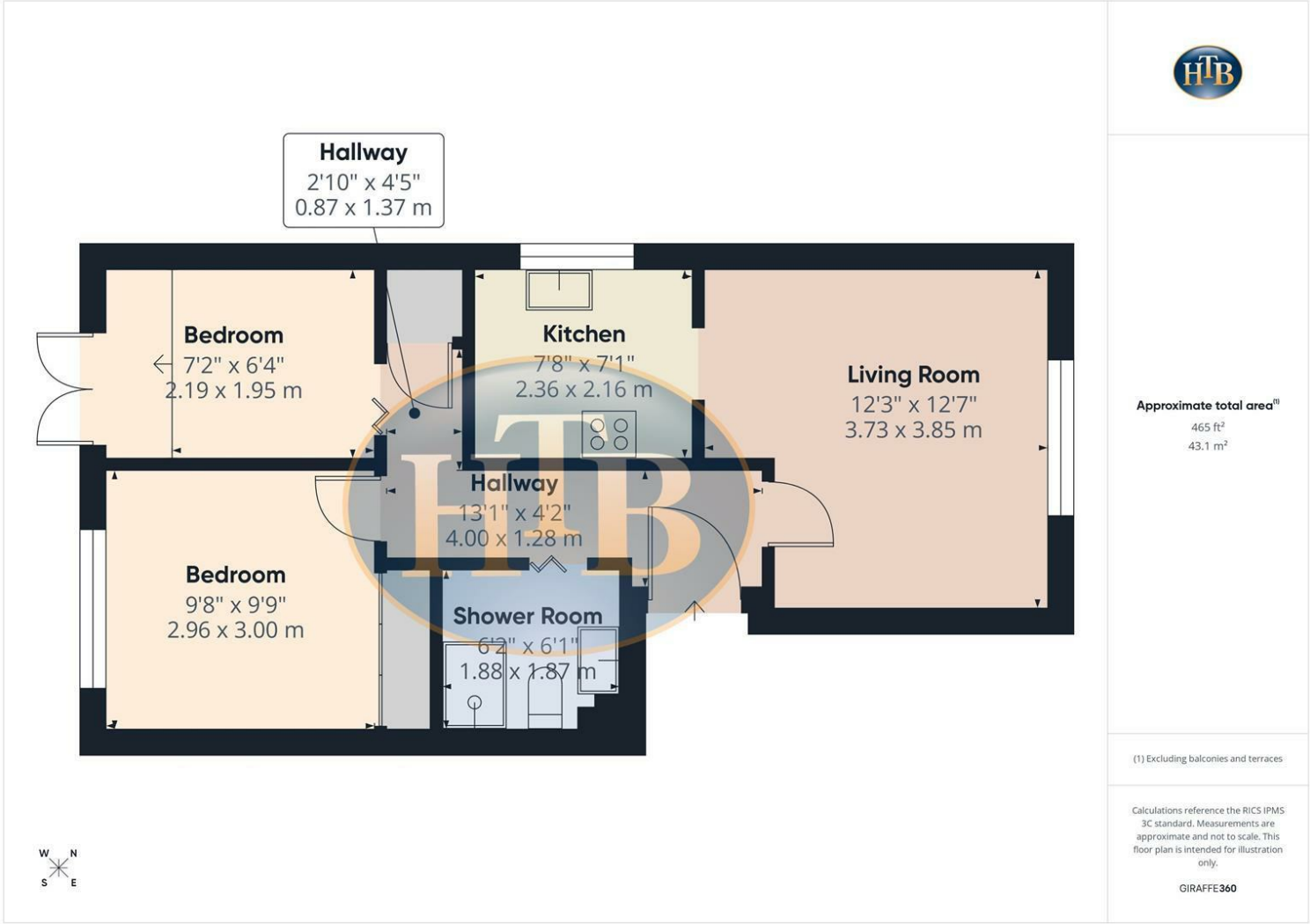

- TWO BEDROOMS
- MODERN FITTED KITCHEN
- SHORT WALK TO WALTON TOWN CENTRE
- BRIGHT AND AIRY LIVING ROOM WITH OPEN FEEL
- BEAUTIFULLY PRESENTED THROUGHOUT
- GROUND FLOOR MAISONETTE WITH DIRECT ACCESS TO COMMUNAL GARDENS
- MODERN SHOWER ROOM
- POPULAR RIVERSIDE DEVELOPMENT
- RESIDENTS PARKING

